

SOLID PLASTIC (HDPE)

TOILET PARTITIONS



Solid Plastic — the material of choice for high-traffic areas and high-abuse applications, or where moisture is a consideration.

Accurate Partitions brings you the best and most cost-effective solid plastic partitions available. Our partitions, available in our classic Pebble Grained texture and durable Tough Texture™ (TT), start in our plastics extrusion plant, where we form our High Density Polyethylene panels (HDPE) on state-of-the-art fabrication equipment. Total control of the solid sheet production allows us to expedite production of our partitions and to be the only solid plastic partition manufacturer to provide them in as little as 48 hours. It also allows us to add compounds such as anti-microbial agents or flame retardants as needed. And our most popular colors are available in 100% post-consumer recycled material.

Accurate™

SOLID PLASTIC (HDPE)

ACCURATE SOLID PLASTIC (HDPE) PARTITIONS

Solid plastic toilet partitions are the ideal choice for high traffic areas. They are environmentally safe and sanitary, never need painting, and will not easily dent or chip. Plus, with the basketball-textured finish standard on all the colors listed on page 3, any effect of vandalism is greatly reduced. It is the material of choice for ease of maintenance.

HDPE solid plastic is waterproof and unaffected by high humidity or corrosive environments and since it is solid material it will not delaminate. Most commercial cleaning agents will not damage the surface.

HDPE solid plastic has homogeneous color and material compound throughout. An aluminum heat sink strip is applied as standard to the bottom edge of all doors and panels.

LEED

Selecting Accurate solid plastic partitions can help you obtain LEED credits.

Accurate Partitions products contribute to LEED certification points as follows:

- Recycled Content: MR4.1 and MR4.2
- Low Emitting Materials: EQ 4.4

STYLES AVAILABLE:

Floor Anchored/Overhead Braced

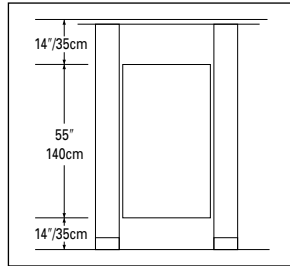
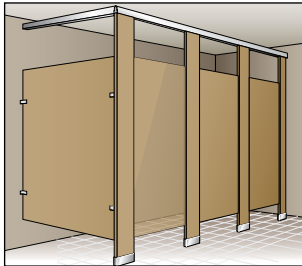

Floor and Ceiling Anchored

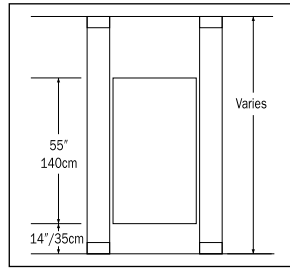
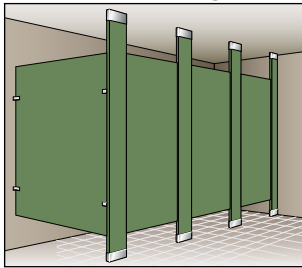

Ceiling Hung

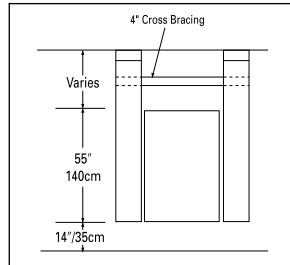
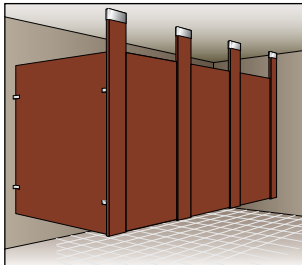

PRIVACY AND URINAL SCREENS

Privacy and Urinal Screens are available in seven, easy to maintain mounting configurations: wall hung, ceiling hung, floor-mounted post, floor-mounted pilaster, floor and ceiling post, floor mounted/overhead braced, and floor and ceiling pilaster.



Wall Hung Screens



Floor Anchored Screens



Post-to-Ceiling Screens

SHOWER DIVIDERS AND DRESSING BOOTHS

Accurate Partitions' Shower Dividers and Dressing Booths are strong and durable to hold up in public shower areas, resisting penetration by water, steam, mildew, odors and soap. The clean, modern design is attractive as well.

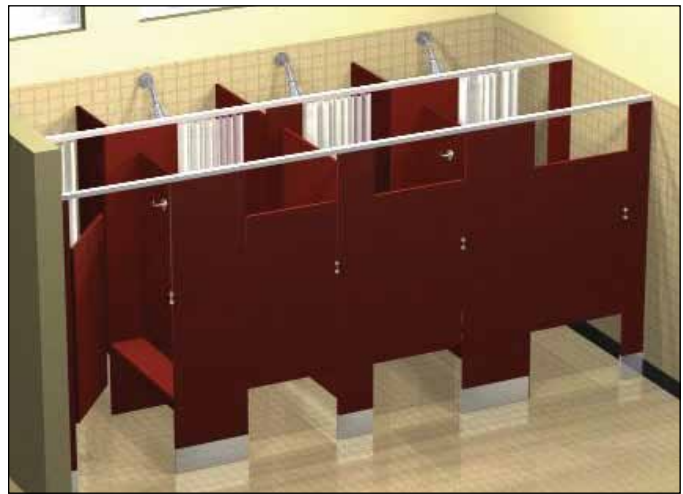

Physically Challenged

Specially designed units are available for the physically challenged, with a wider front entry for easy wheelchair access.

SOLID PLASTIC (HDPE)

COLOR SELECTION:



White 9201



Cream 9235



Tan 9202*



Grey 9200*



Charcoal 9237*

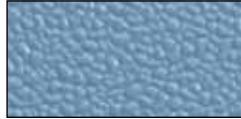

Azure 9231

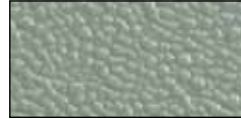

Moss 9233*



Blue 9509

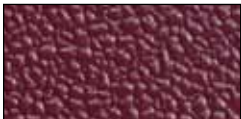

Burgundy 9211



Black 9205*



Black Confetti 9217



Folkstone Grey 9400

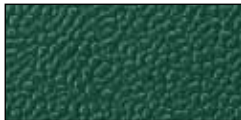

Hunter Green 9508



Ivory Essence Speckle
9500



Mocha 9212



Olive 9223

**Available in 100% post-consumer recycled material*

AVAILABLE FINISHES:



Pebble Grained

Available in all colors



Tough Texture™ (TT)

Available in only solid colors

WE'VE GOT THE PRODUCT AND HARDWARE CHOICES TO MATCH ANY APPLICATION

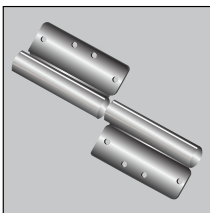

HINGES

- **8" Aluminum:** Mainstream Choice
- **Vault:** Maximum Performance, Aesthetics
- **Continuous Stainless Steel**
- **Integral**

All Available With Lift Emergency Access

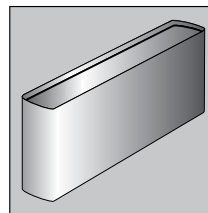

SHOES

- Stainless Steel
- Plastic

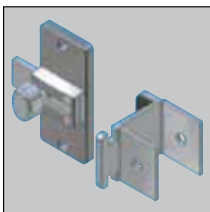

STRIKE/KEEPERS

- **6":** Mainstream Choice
- **Wrap-Around:** Aesthetics

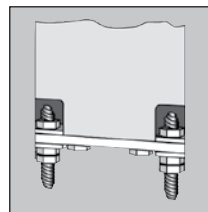

MOUNTING SYSTEM

- Heavy Duty for Maximum Rigidity and Durability

• CONTINUOUS BRACKETS

Available in Aluminum, Stainless Steel and Plastic

• VANDAL-RESISTANT FASTENERS

SOLID PLASTIC (HDPE)

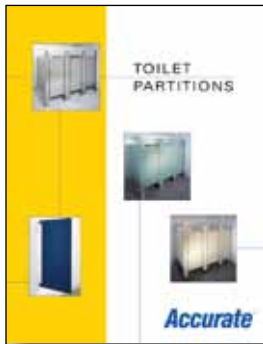

Visit us on the web, accuratepartitions.com for our complete line of partitions.



Visit Accurate Partitions' affiliated companies, American Specialties, Inc. and ASI Storage Solutions Inc., at americanspecialties.com and asilockers.com, respectively, for all your washroom and storage needs.



ADA CODE REQUIREMENTS:

Accurate Partitions has been a pioneer in the design of facilities for the physically challenged. Our engineers stand ready to assist in layout design to meet code or special requirements.

SPECIFICATIONS

If you need complete specifications or additional information, you will find it on our website: accuratepartitions.com.

As always, Accurate Partitions' customer service is ready to assist you with any and all needs!

The color charts shown in this catalog are printed reproductions and are for descriptive purposes only. Color selection cards are available upon request. Accurate Partitions reserves the right to change specifications and products without notice.

Accurate

Accurate Partitions Corp.
P.O. Box 287, Lyons, IL 60534
Tel: 708.442.6800 Fax: 708.442.7439
E-mail: info@accuratepartitions.com Web: accuratepartitions.com